

SCULPFUN B70 Enclosure

Assembly Instructions

Packing List:

- | | | | |
|--------------------------------------|---------------------|-------------------------------------|----------------------------------|
| A Assembly connector *27 | D Fan | F Exhaust pipe | I Fan power adapter cable |
| B Acrylic sheet *10 | E Flange | G Double faced adhesive tape | J Power adapter |
| C Acrylic sheet components *3 | F Hose clamp | H Toolkit *5 | |

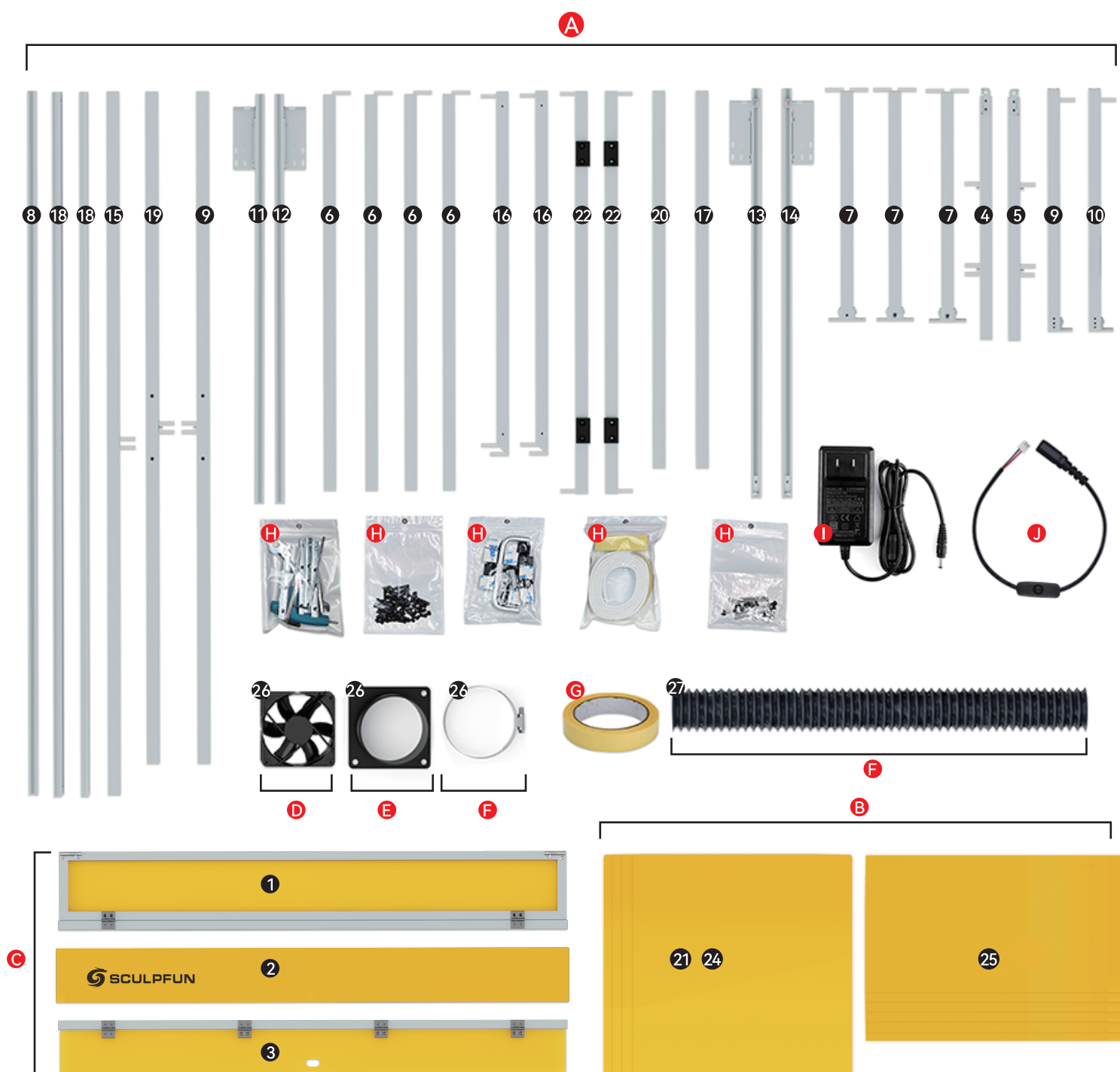

The figure is for assembly illustration only. For detailed installation instructions, please scan the QR code to watch the installation tutorial video.

(Assembly Illustration)

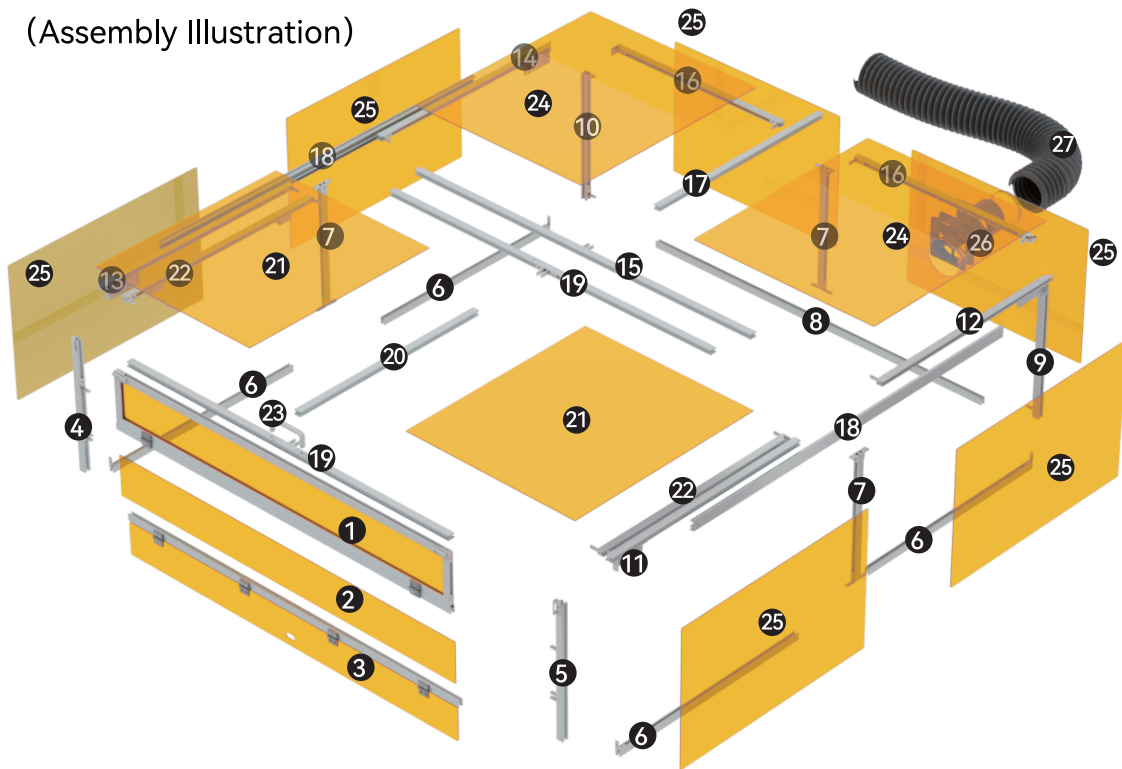

(Completed)

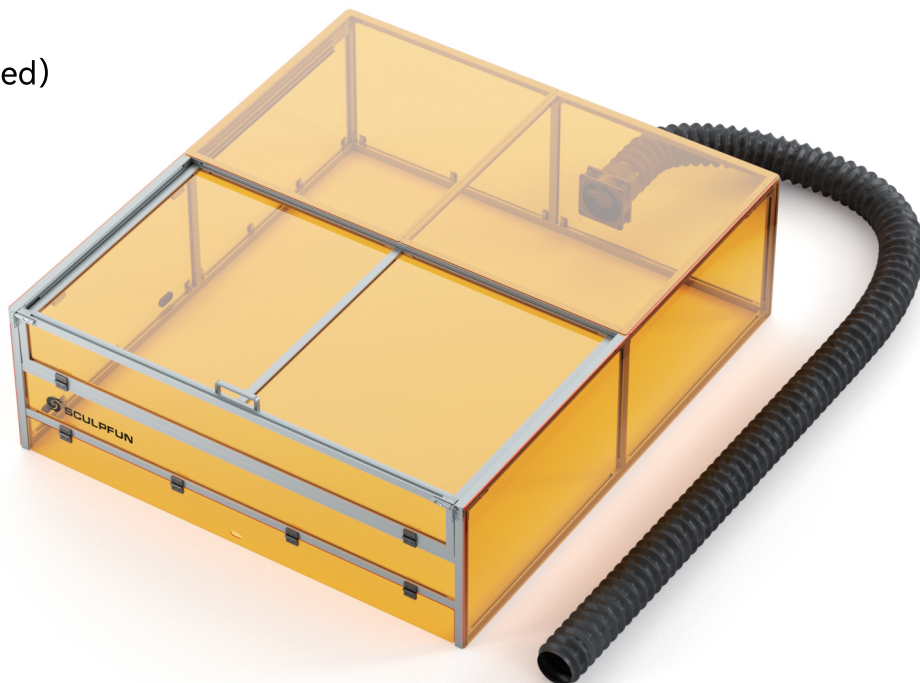

Scan the QR code for more help and YouTube installation tutorial videos.
For laser engraving technical support and services, please send an email to:
support@sculpfun.com